



KVM-9005

KVM Cat.5 Extender Kit

H/W Version: 3

LevelOne's KVM-9005 Cat.5 KVM Extender allows you to locate PC, SERVER or KVM SWITCH up to 500feet /150m away from your controlling keyboard, mouse and VGA monitor using popular and inexpensive Ethernet cabling. The extender includes two devices, a "KVM-9005T transmitter" to synthesize the keyboard/mouse/VGA monitor signal for easy long-distance transmission over popular Ethernet CAT.5 cable and a "KVM-9005R receiver" to retrieve the synthetic signal back to keyboard/mouse/VGA monitor signal.

The Cat.5 Extender uses the existing network construction to transfer console signals to remote

sides. You just need to install a pair of transmitter and receiver into local and remote sides individually to provide you with the flexibility needed to control server groups either from a remote side (from the transmitter) or from a local site (from receiver).

With its compact design, our Cat.5 Extender easily fits on a desk or any limited space. No software or interface card is required. You can easily active this device by simply connecting it to the power source (only required for receiver) and to the network cable, further saving cable layout and cable installation cost.

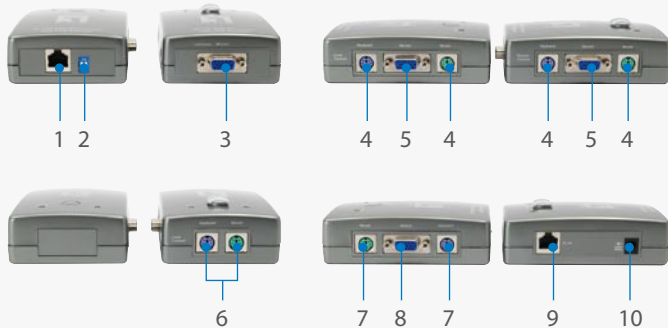

1. RJ45 Port
2. Dip Switch
3. VGA Console Port
4. PS/2 Console Port
5. VGA Console Port
6. PS/2 Console Port
7. PS/2 PC Port
8. VGA PC Port
9. RJ45 Port
10. Power Jack
11. PC1/PC2 LEDs
12. VGA Tuning
13. Power LED
14. Status LED

Key Features

- Remote console up to 150m
- Dual user access: at sender and receiver
- Supports Cat. 5/6/7
- Superior high VGA resolution up to 1280 x 1024
- LEDs for power and data transfer
- Receiver with knob for manual video signal tuning
- Works with KVM Switches and single PC
- No software necessary
- Easily install in few minutes
- Includes cable 0.9m (from PC or KVM switch to console)
- Compatible with DOS, MS Windows, Linux, Unix and Netware

Related Products



ACC-1000
KVM Cat.5 Console Module



KVM-9007
KVM Cat.5 Console Receiver

Technical Specifications

KVM-9005T (Transmitter)

PS/2 Keyboard port

1

PS/2 Mouse port

1

VGA port

1

Console port connector (all female type)

PS/2 purple mini-din 6 pin for keyboard

PS/2 green mini-din 6 pin for mouse

VGA blue HDDB 15 pin

PC port connector (all female type)

PS/2 purple mini-din 6 pin for keyboard

PS/2 green mini-din 6 pin for mouse

VGA blue HDDB 15 pin

RJ-45 port connector

8P8C (same as Ethernet 100BASE-Tx port)

LED

Powr, Data

Knobs (for VGA tuning)

No

Size

111.5(L) x 75(W) x 35.5(H) mm

Power adapter

From Keyboard

Weight (g)

134g

Temperature

Operating: 0°C~50°C

Humidity

Operating: 0%~80%, Non-Condensing

Certification

FCC, CE

KVM-9005R (Receiver)

PS/2 Keyboard port

1

PS/2 Mouse port

1

VGA port

1

Console port connector (all female type)

PS/2 purple mini-din 6 pin for keyboard

PS/2 green mini-din 6 pin for mouse

VGA blue HDDB 15 pin

PC port connector (all female type)

PS/2 purple mini-din 6 pin for keyboard

PS/2 green mini-din 6 pin for mouse

VGA blue HDDB 15 pin

RJ-45 port connector

8P8C (same as Ethernet 100BASE-Tx port)

LED

Powr, Data

Knobs (for VGA tuning)

1

Size

111.5(L) x 75(W) x 35.5(H) mm

Power adapter

External Power, DC12/1A

Weight (g)

120g

Temperature

Operating: 0°C~50°C

Humidity

Operating: 0%~80%, Non-Condensing

Certification

FCC, CE

Product Diagram

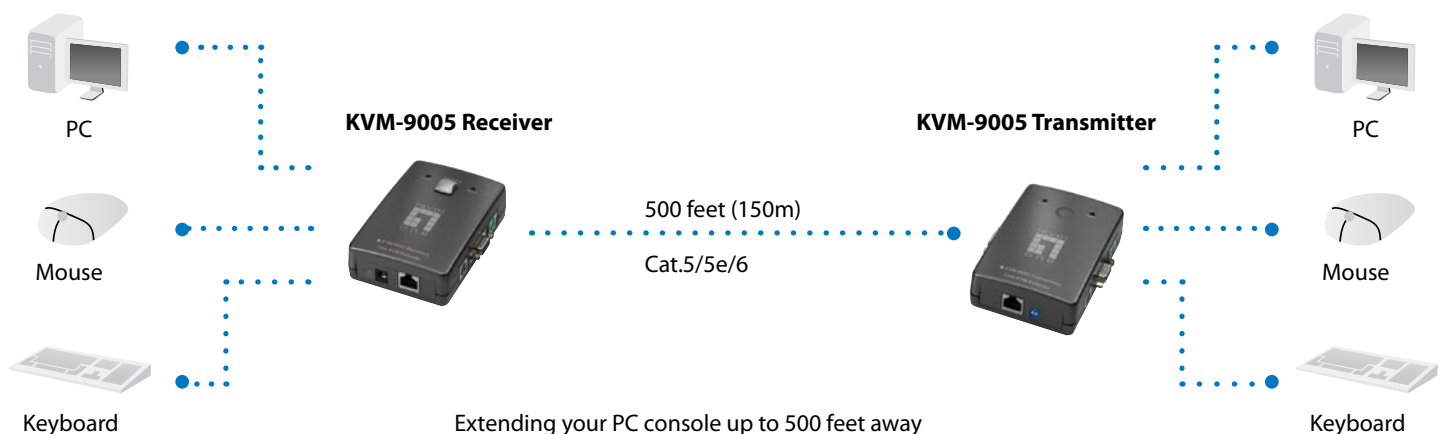

Order Information

KVM-9005: Cat.5 KVM Extender (incl. Cable)

KVM-9005T: Cat.5 KVM Extender Transmitter

KVM-9005R: Cat5 KVM Extender Receiver

Package Contents

KVM-9005 Transmitter + Receiver, Power Adapter, Console Cable, User Manual