

Outdoor Antenna Installation

Before installation, please ensure you have the required products and that the contents of each product are complete.

1

Dismount the dipole antenna from your indoor access point / router.

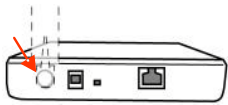

2

Attach the connector of the extension cable to your WiFi Device *Extension cable is not included

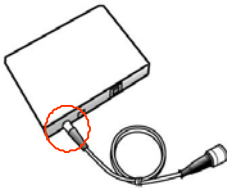

3

Connect the connector of the extension cable to surge arrester.

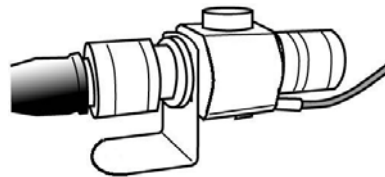

4

Connect remaining surge arrester connector to the low loss cable

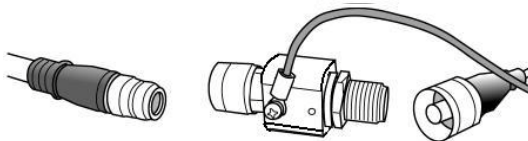

5

Connect the remaining N connector to the Antenna

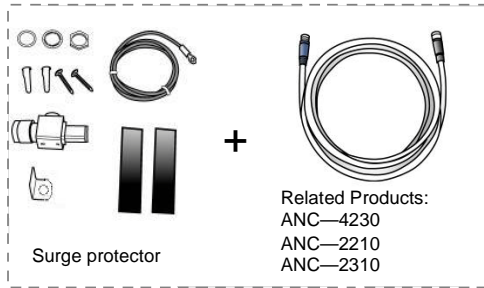
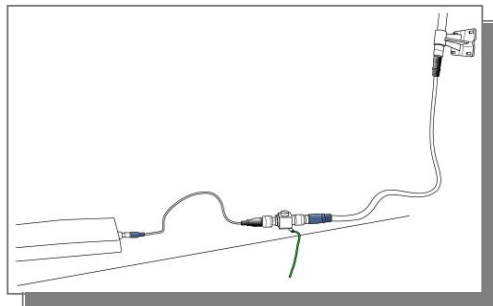
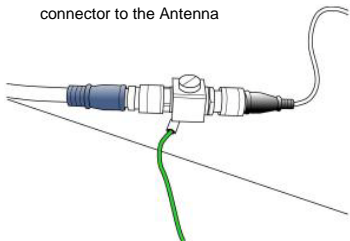

Related Products:
ANC—4230
ANC—2210
ANC—2310

You have to know how to assemble the surge arrester

1

Before installing the antenna, make sure the purchased extension cable can reach the location of your wireless devices.

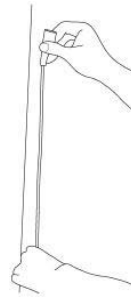

2

Take out the L-type metal bracket and mark the mount position on the wall.

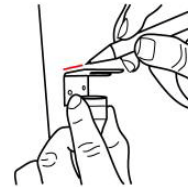

3

Screw it to the wall

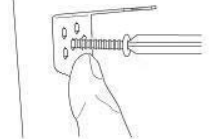

4

Seat the arrester into bracket

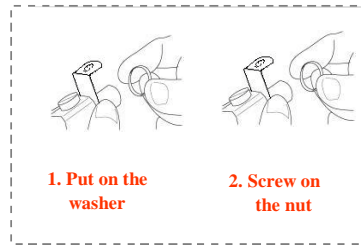
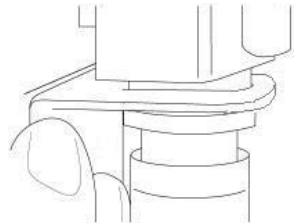
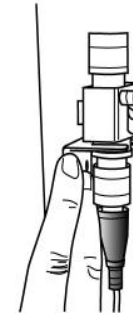

1. Put on the washer

2. Screw on the nut

Weather-proof tape for outdoor installations

If your surge protector is installed outdoors, remember to wrap both connectors tightly with the enclosed water-proof tape after screwing on the cable connectors.

