



IP CamSecure Pro Series Surveillance Management Software



FCS-9100 Series
FCS-9200 Series
FCS-9400 Series

Powerful Surveillance Management Software

LevelOne has developed intelligent and advanced featured surveillance management software that compliments our digital IP Surveillance Cameras. Features such as a Smart Guard system and Smart Search system allows for general monitoring of motion, missing objects, foreign objects and camera occlusion.

This Smart Guard and Smart Search system is currently the most advanced surveillance software available in the surveillance market.

Smart Guard and Smart Search

The most exciting new features of the IP CamSecure software are the Foreign Object and Missing Object reporting feature. When monitoring an area, any foreign objects that do not belong there, such as bags, boxes, cars and people will trigger an alarm. So too is the Missing Object feature a valuable inclusion to monitor specific objects within a monitoring area. Once these objects are removed, an alarm is triggered notifying users about unsolicited activity.

Instant Actions and Notifications

IP CamSecure has several notification features that enable a surveillance system to monitor and report on certain activities. Notification includes on-screen display, sounding alert, e-mail alert, phone call alert, digital signal out and P/T/Z pre-set go.

Optimized Surveillance

Most surveillance systems still rely on traditional analogue CCTV Cameras for monitoring protected areas. To incorporate both digital IP Cameras and analogue CCTV Cameras in one system not only maximizes efficiency but also adds digital surveillance functionality.

LevelOne IP CamSecure enables users to use both digital and analogue cameras in one system for maximizing surveillance investment without immediate replacement of currently used systems. The surveillance software supports digital and analogue to provide a complete monitoring and surveillance management system.



FCS-9100 Series



FCS-9200 Series



FCS-9400 Series

Key Features

- Monitor up to 64 channels simultaneously
- Dual monitor supported for live view and playback simultaneously
- "Smart guard" event analysis and instant response to monitor larger areas more efficiently
- "Smart search" for easy locating of recorded events as well as multi-events viewer and filter
- Enhance images of recorded video
- "Counting application" for objects amount control
- Supports Web-based and 3G mobile remote monitoring
- Complete system and event log database
- Relies on hard disk drive storage instead of video tapes
- Broadcast live video over the Internet for remote viewing
- Support both digital and analogue cameras in one system
- Control pan/tilt/zoom features on cameras

Technical Specification

Max # of Cameras Live View, Monitor and Record

4 Channels:

FCS-9104	IP CamSecure Pro4
FCS-9204	IP CamSecure Pro4 Plus
FCS-9404	IP CamSecure Pro4 Mega

8 Channels:

FCS-9108	IP CamSecure Pro8
FCS-9208	IP CamSecure Pro8 Plus
FCS-9408	IP CamSecure Pro8 Mega

16 Channels:

FCS-9116	IP CamSecure Pro16
FCS-9216	IP CamSecure Pro16 Plus
FCS-9416	IP CamSecure Pro16 Mega

32 Channels:

FCS-9132	IP CamSecure Pro32
FCS-9232	IP CamSecure Pro32 Plus

25 Channels:

FCS-9425	IP CamSecure Pro25 Mega
----------	-------------------------

36 Channels:

FCS-9436	IP CamSecure Pro36 Mega
----------	-------------------------

64 Channels:

FCS-9164	IP CamSecure Pro64
FCS-9264	IP CamSecure Pro64 Plus
FCS-9464	IP CamSecure Pro64 Mega

Compatibility

*Compatible with LevelOne IP cameras.
More IP cameras of other major manufacturers supported in FCS-92xx and FCS-94xx.

Multi-Language Embedded

Turkish, Traditional Chinese, Simple Chinese, Danish, Japanese, Hungarian, Spanish, Greek, French, Finnish, Russian, English, Thai, Czech, Slovak, Korean, Italian, Portugal Portuguese, Brazil Portuguese, German, Farsi and Hebrew.

Hybrid Camera Management

Monitor IP digital and CCTV analog cameras in one surveillance system

Dual Monitor

User is able to monitor multiple channels with reasonable image size or live view and playback simultaneously

Smart Guard

Events triggered by general motion detection, missing/foreign object detection, signal lost, camera occlusion, lose focus, external input or system status

Motion Detection

Camera-based motion detection with image exclude filter for image areas of no interest in specific period

Smart Search

Search unusual events with specific parameters from recorded video

Alarm Notification

Play sound, send emails, send SMS message, make phone calls, PTZ PRESET GO, signal digital output, on screen display and instant recording.

Counting Application

Count how many times objects moving between different locations

Video Compression

MJPEG / MPEG-4

Audio

Support full duplex real time audio

User Account

Multiple user authentication levels with password restriction rules for unlimited users

Log Viewer

All unusual events ,system events by date/time and/or cameras

Recording

Continuous recording, manual recording/snapshot, record by schedule, record by digital input or triggered event, and record moving only (pre/post record buffer is up to 60 seconds).

3GPP

**Monitor in 3G mobile devices which are equipped with 3G video playback.

DDNS

Support DtDNS and Dynu.

Upgrade

No extra charge required for the further upgrade

Playback

Simultaneously Playback

16 Channels

Image Enhancer

Improve recorded video to get better image during playback and can be applied during export

Search for Recordings

Search for recordings based on date, time or specific video parameters.

Playback

Controllable speed 1/16x~16x or frame by frame

Video Clip Export

Export single BMP/JPEG images to file or printer
Export video in AVI

P/T/Z and I/O

PTZ Support

Control of PTZ cameras and preset positions

Preset Patrolling

Multiple cameras patrolling

Go to Preset on Event

Yes

Input/Output Control

Support digital input/output control

Remote Access via Remote Client Application

Remote Client Application

Remote live Viewer/ Remote Playback

PTZ Support

Control of PTZ cameras

Max # of Cameras Live View

Up to 16 Channels from different servers

Max # of Cameras Playback

Up to 16 Channels

Remote Access via Web Browser

Max # of Cameras Live View

Up to 4 Channels

Minimum System Requirements

CPU

Intel P4 2.8 GHz

RAM

512MB

Mother Board

Intel 945 or 965 chip or above

MB vendor ASUS with Intel chipset recommended

Video Card

ATI Radeon 9200, nVIDIA GeForce FX-5200, Intel 945G/965G or above (ATI recommended)

Hard Disk

80GB or above

OS

MS Windows 2000/XP Pro SP2/2003/Vista

Supported Camera Models

	IP CamSecure Pro Series	IP CamSecure Pro Plus Series	IP CamSecure Pro Mega Series
Model name	FCS-91 04/08/16/32/64	FCS-92 04/08/16/32/64	FCS-94 04/08/16/25/36/64
Camera Support			
LevelOne	FCS-0010, FCS-0020, FCS-1010, FCS-1030 V1.0, FCS-1030 V2.0, FCS-1040, FCS-1050, FCS-1060, FCS-1070, FCS-1081, FCS-1081A, FCS-1091, FCS-1101, FCS-3000, FCS-0031, FCS-3021, FCS-4x00, FCS-7011, WCS-0010, WCS-0020, WCS-1090, WCS-2010 V1.0, WCS-2010 V2.0, WCS-2030 V1.0, WCS-2030 V2.0, WCS-2030 V3.0, WCS-2040, WCS-2060, WCS-2070, FCS-4010, FCS-5011, FCS-5030, FCS-8005, FCS-8004		
ACTi		SED 2100, SED 2120, SED 2140, SED 2400, SED 2420, SED 2600, SED 2610, SEM 1110, ACM SERIES, CAM 5300, CAM 5130, CAM 5140, CAM 5150, CAM 5500, CAM 6100, CAM 6200, CAM 6500, CAM 6510, CAM 6520, CAM 6600, CAM 7100, CAM 7120, CAM 7200, CAM 7220, CAM 7300, CAM 7320, CAM 6620, SED 2310, SED2320, CAM 5200, CAM 5XXX, CAM 6220, CAM 6XXX, CAM 7XXX, SEM 1XXX	
Arecont Vision			AV1300, AV2000, AV2100, AV3100, AV3130, AV5100, AV8180, AV8360
ATLANTIS LAND		A02-OIPCAM1, A02-OIPCAM2, A02-OIPCAM3, A02-IPCAM5, A02-IPCAM6, A02-IPCAM7, A02-IPCAM8, A02-IPCAM9, A02-IPCAM10, A02-IPCAM11, A02-IPCAM12, A02-IPCAM13, A02-IPCAM14, A02-IPCAM15, A02-IPCAM16, A02-IPCAM17	
AXIS		205, 206, 206M, 206W, 207, 207W, 207MW, 209FD, 210, 210A, 211, 211A, 212, 213, 214, 215, 216FD, 221, 225FD, 231D, 232D, 240Q, 241Q, 241QA, 241S, 241SA, 242S, 2460, 233D	205, 206, 206M, 206W, 207, 207W, 207MW, 209FD, 210, 210A, 211, 211A, 212, 213, 214, 215, 216FD, 221, 225FD, 231D, 232D, 240Q, 241Q, 241QA, 241S, 241SA, 242S, 2460, 233D
D-Link		DCS-6620, DCS-6620G, DCS-5220, DCS-5300, DCS-5300G, DCS-2120, DCS-3420, DCS-3220, DCS-3220G, DCS-2100, DCS-2100G, DVS-104, DVS-301, DCS-900, DCS-G900, DCS-950, DCS-950G	
ETROVISION		EVxx10	
Hitron		HNCE-E1SN, HNG-E1SAW054, HWD125MN, HECMC4V0C4	
FINE		TCP-690, TCP-690DN, TCP-HP930, WB-8211SD, WB-8411, CDV-3V930, TCP-690U, TCP-HP930U, WB-8211SDU, CDV-3V930U, EP-936, EP-908, EP-601, EP-201, EP-221, EP-221DN	
IQin			IQeye301, IQeye301m, IQeye301w, IQeye302, IQeye302w, IQeye303, IQeye303w, IQeye501, IQeye511, IQeye601, IQeye602, IQeye603, IQeye701, IQeye702, IQeye703, IQeye705, IQeye751, IQeye752, IQeye753, IQeye755
JVC		VN-C20U, VN-E4(U), VN-C205U, VN-C215U, VN-C655U	
Lumenera		le045c, le045c-dn, le075c, le075c-dn	le045c, le045c-dn, le075c, le075c-dn, le165c, le165c-dn, le175c, le175c-dn, le259c, le275c, le275c-dn, le375c, le375c-dn, le11059c
MOBOTIX		M12D-IT-DNight, M22M-IT, D12Di-IT	M10D-Night, M12D-Sec, M12D-IT-DNight, M12D-Sec-Dnight, M12M-Web, M22M-IT, M22M-Sec, M22M-Sec-Night, D12Di-IT, D12Di-Sec
Panasonic		BB-HCM311, BB-HCM331, BB-HCM371, BB-HCM381, BB-HCE481, BB-HCS301, BB-HCM511, BB-HCM515, BB-HCM581, BL-C10, BL-C1, BL-C20, BL-C30, BL-C111, BL-C131, KX-HCM110, KX-HCM280A, WV-NP472, WV-NS324, WV-NF284, WV-NP1000, WV-NP1004, WV-NM100, WV-NP240, WV-NP244, WV-NS202, WV-NW484, WV-NW964	
PiXORD		100, 120/126/128, 200/206, 201, 205, 207, 240, 241, 261, 262, 263, 300, 400/42X, 461, 463, 1000, 1401, 2000, 4000, 8504, 405, 405M, 410, 411/412	
PLANET		ICA-510, ICA-700, ICA-151W, ICA-151, ICA-750, ICA-107W, ICA-107P, ICA-107	
PROBE		IP Fixed Camera, IP PTZ Camera	
SAMSUNG		C6475	
SONY		SNC-DF40, SNC-DF70, SNC-P1, SNC-P5, SNC-RZ25, SNC-RZ50, SNC-RX550, SNC-CS50, SNC-CS3, SNC-Z20, SNC-RZ30, SNC-CS10, SNC-CS11, SNT-V704, SNC-RX530, SNC-DF50, SNC-DF80	

Supported Camera Models

	IP CamSecure Pro Series	IP CamSecure Pro Plus Series	IP CamSecure Pro Mega Series
Model name	FCS-91 04/08/16/32/64	FCS-92 04/08/16/32/64	FCS-94 04/08/16/25/36/64
Camera Support			
TOSHIBA		IK-WB02A, IK-WR01A	IK-WB02A, IK-WR01A, IK-WB21A, IK-WB15A
VIVOTEK		VS 2101, VS 2401, VS 2402, VS 2403, VS 3100, VS 3101, VS 3102, VS 3102-XLTH, VS 3103, VS 3107, VS 3108, VS 6000, VS 6100, VS 6104, VS 7000, VS 7101, SD 6000, SD 6101, SD 61x2, FD 6000, FD 61x1, FD 61x2, TC 5330, TC 5331, TC 5630, TC 5631, IP 21x1, IP 21x2, IP 31x1, TLFN, IP 31x1, IP 31x2, IP 31x7, IP 31x8, IP 3129, IP 3132, IP 3133, IP 3134, IP 3135-PLNX, IP 3135, IP 3136-PLNX, IP 3136, IP 3137, IP 51x2, IP 51x4, IP 5104, IP 5114, IP 5124, IP 5134, IP 6000, IP 61x2, IP 61x4, IP 61x7, IP 6104, IP 6114, IP 6124, IP 6134, IP 7000, IP 71x4, IP 71x7, IP 7135, IP 7136, IP 7137, IP 7151, IP 7152, PT 31x2, PT 31x3, PT 31x4, PT 31x7, PT 31X2, PT 31X3, PT 3134, PT 51x4, PT 5104, PT 5114, PT 5124, PT 5134, PT 6000, PT 61x4, PT 6104, PT 6114, PT 6124, PT 6134, PT 7000, PT 7135, PT 7137, PZ 6000, PZ 61x2, PZ 61x4, IP 7131, IP 7132, IP 7138, IP 7139, VS 7100, FD7131, SD7151, IP7142	
ZAVIO		D611E, D611A, D610A, F611E, F611A, F610A, V111T, S610A, F721E, F721A, F720A, F711E, F711A, F710A, F211A, F210A, F212A, F310A, F312A, M210A, M212A, M610A, M612A, F613A, F510E, F510W, F511E, F511W, F711E, F710E, D510E, D511E, M310A, M312A	

*Please visit <http://global.level1.com> for the compatible product list.

**This feature depends on the mobile telecom service provided and the mobile phone model. LevelOne does not guarantee that this feature will work in all countries.

***The specification is subject to change. Please visit <http://global.level1.com> for the latest specification.

Product Diagram

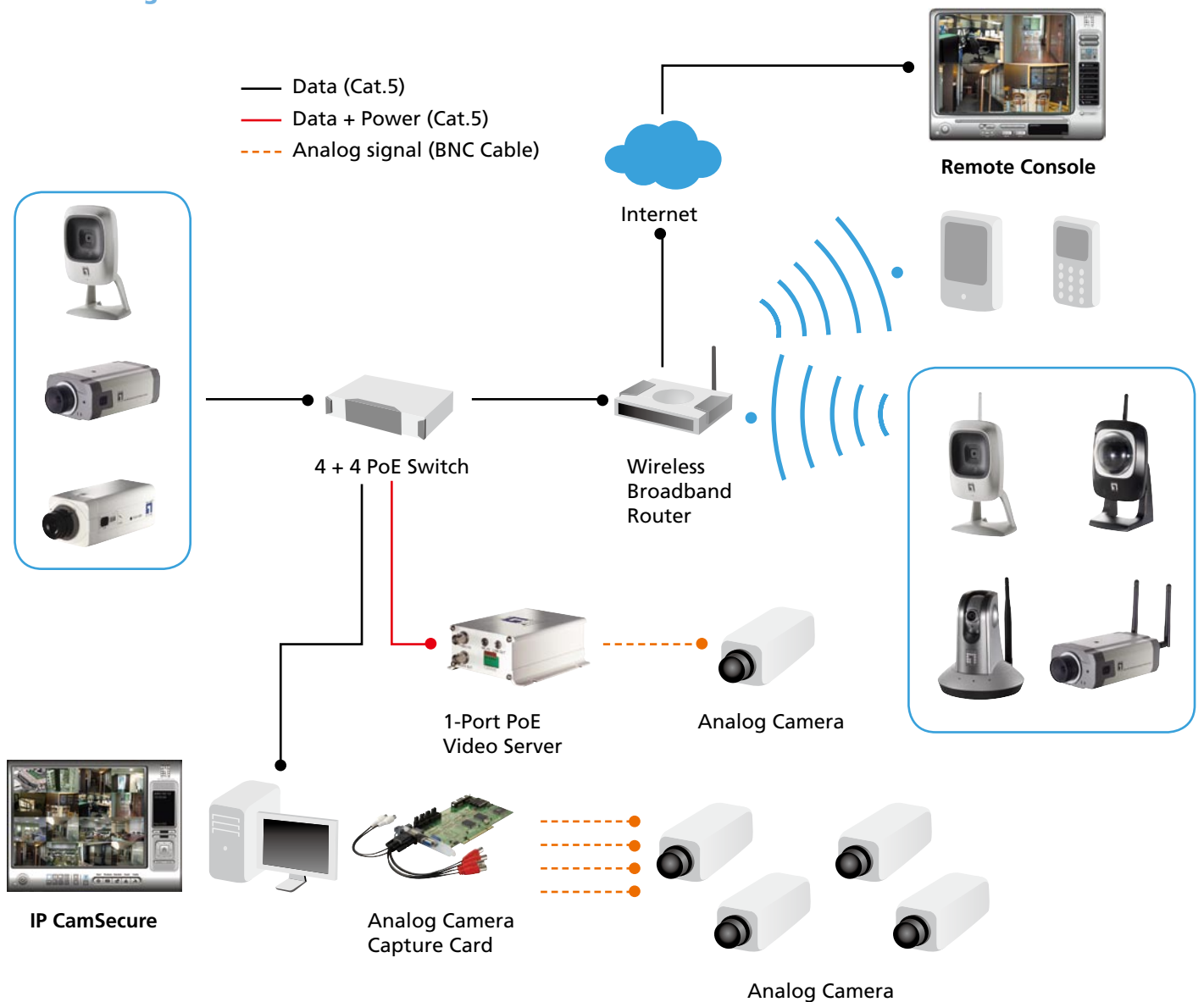

Order Information

FCS-9104: IP CamSecure Pro4
FCS-9108: IP CamSecure Pro8
FCS-9116: IP CamSecure Pro16
FCS-9132: IP CamSecure Pro32
FCS-9164: IP CamSecure Pro64
FCS-9204: IP CamSecure Pro4 Plus
FCS-9208: IP CamSecure Pro8 Plus
FCS-9216: IP CamSecure Pro16 Plus
FCS-9232: IP CamSecure Pro32 Plus
FCS-9264: IP CamSecure Pro64 Plus
FCS-9404: IP CamSecure Pro4 Mega
FCS-9408: IP CamSecure Pro8 Mega
FCS-9416: IP CamSecure Pro16 Mega
FCS-9425: IP CamSecure Pro25 Mega
FCS-9436: IP CamSecure Pro36 Mega
FCS-9464: IP CamSecure Pro64 Mega

Package Content

CD Manual / Utility
USB Dongle
Quick Installation Guide