



H.264 Megapixel PIR Lighting IP Camera



FCS-0030

H/W Version: 1

LevelOne FCS-0030 is designed for 24-hour home security and surveillance. It provides a distinct and stylish exterior mount unit with excellent features and quality, allowing plenty support of applications and wide area of coverage. Users can view the live motion image anywhere through web browser via the Internet. With the mega pixel progressive sensor and white LED, FCS-0030 comes with high resolution quality and harp sensitivity – an ideal solution for your day-and-night surveillance system.

In addition, FCS-0030 provides many advanced features, including Human detection sensor (PIR), Micro SD card slot and Privacy button. With "Easy Installation Wizard", this LevelOne IP camera is very user friendly, perfect for both home and/or business use. It also embedded with a high performance image sensor and CPU. FCS-0030 supports MPEG-4 / MJPEG / H.264 codec compression, providing high resolution at 640 x 400 or 1280 x 800 for high-quality video and real-time viewing.

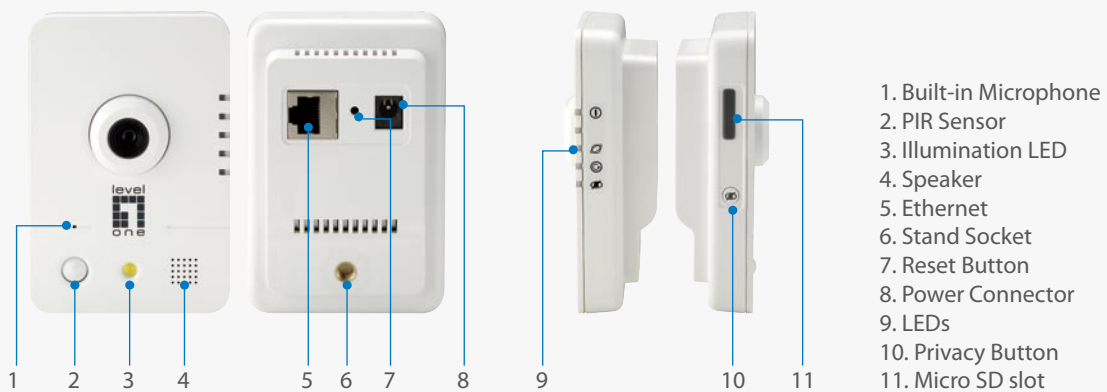

Key Features

- Supports Megapixel up to 1280x800
- Support H.264 / MPEG-4 and MJPEG Codec Compression
- Built-in PIR Sensor for Human temperature Detection
- Built-in white LED for low lux
- Built-in MIC and Speaker
- Built-in micro SD/SDHC memory card slot
- Bundled with 32-Channel LevelOne IP CamSecure Lite surveillance management software
- Remote Access with Level1DNS™ Service

Works Well With



WBR-6022
HomeGuard22 Residential Gateway



POS-1000
Power Over Ethernet Splitter

Technical Specification

Image Sensor

Sensor Type : 1/4" MegaPixel CMOS Sensor
 Sensor Resolution : 1280 x 800 pixel
 Minimum Illumination :
 1 Lux (without LED)
 0 Lux (with LED)

White LED

LED light distance up to 6m
 Triggered by Auto PIR Sensor

Lens

Lens Type: Board Lens
 Focal Length: f=3.6mm/F=2.3
 View Angle: H: 55.7°, V: 36.5°

Video

Image Compression: H.264 / MPEG4 / MJPEG
 Auto Exposure Control / Auto White Balance /
 Auto Gain Control

Video Record

Store to PC: .asf
 Store to SD card:.mp4

Image Resolution and Frame Rate:

1280 x 800: 30fps
 640 x 400: 30fps

Audio

Audio Streaming: Two-way audio
 Audio Code: G.711/AMR
 Built-in MIC & Speaker

Zoom

Digital Zoom: 4x

Communication

Ethernet: one 10/100Mbps RJ-45
 Supported Protocols: TCP/IP, UDP, ICMP, DHCP, NTP, DNS, DDNS,
 SMTP, FTP, HTTP, Samba, PPPoE, UPnP, Bonjour, RTP, RTSP, RTCP,

Hardware

Flash ROM: 16MB
 RAM:64M DDR

Interface & Buttons

Passive infrared sensor (PIR)
 Micro SD/SDHC card slot
 DC Power Connector
 Ethernet Cable Connector
 Privacy Button
 Reset Button

LEDs

Power/Ethernet states/ Privacy

Power

Output: DC12V / 1 A (Power Adapter)

Power consumption

Max Power Consumption: 6W

Environment

Operating Temperature: 0°C ~ 50°C (32°F ~ 122°F)
 Operating Humidity: 10% ~ 80%

Dimension (L x W x H)

29mm X 60mm X 95mm

Software

Bundled with 32-Channel LevelOne IP CamSecure Lite
 surveillance management software

Viewing System Requirement

OS: Microsoft Windows 2000/XP/Vista
 Browser: IE 6.x or above
 3GPP Player: Real Player 10.5 , Quick Time 6.5 or above

Certification

FCC, CE

Product Diagram

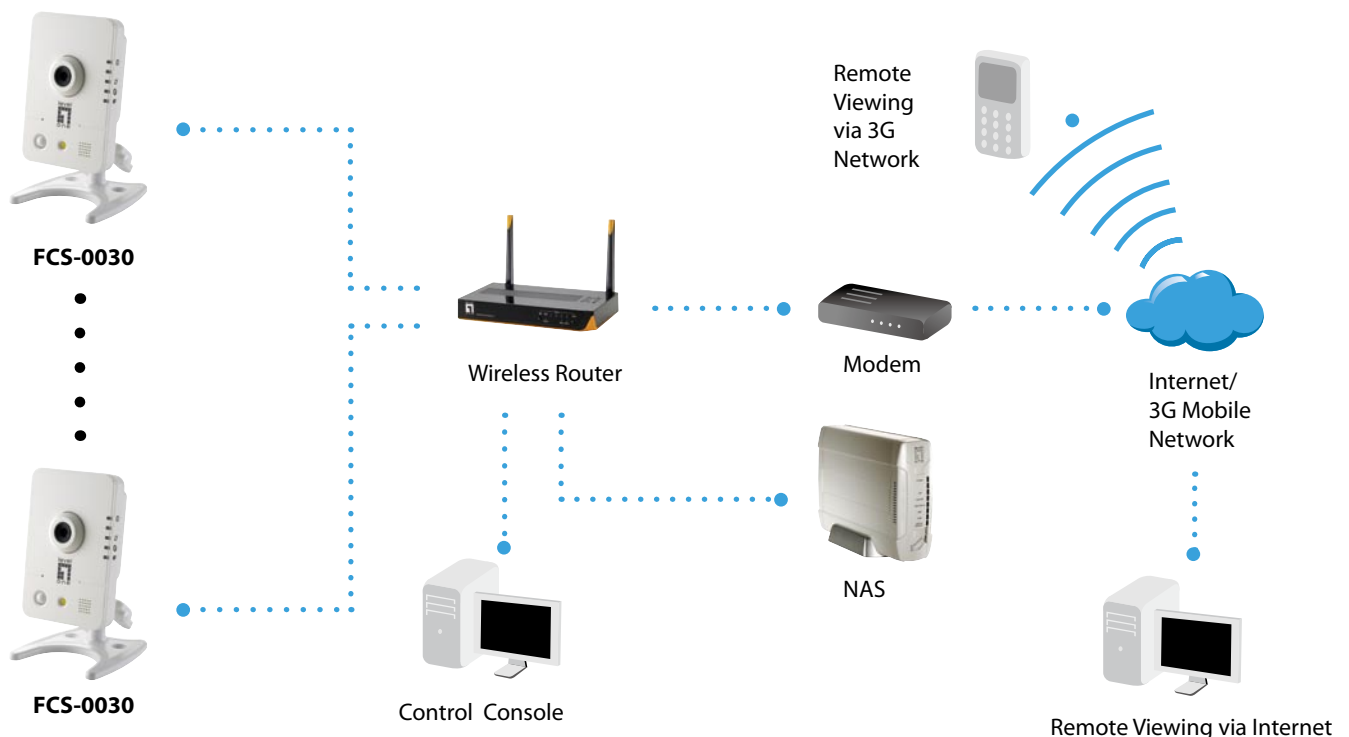

Order Information

FCS-0030: H.264 Megapixel PIR Lighting IP Camera

Package Contents

FCS-0030

Power Adapter

RJ-45 Ethernet LAN Cable

Quick Installation Guide

CD Manual / Utility